

NIRVANA



SPECIFICATIONS

Length : 18.28 Meters 60 Feet
Beam : 8.57 Meters 28 Feet
Draft: 1.45 Meters 4.8 Feet
Rig: sloop
Number of crew: 2
Built: 2009
Builder: FOUNTAINE PAJOT – ELEUTHERA
Naval architects: BERRET/RACOUPEAU
Flag: French
Hull construction: composite
WIFI

ACCOMMODATION

Number of cabins: 4
3 double + 1 triple + 1 single child
2 double back cabins convertible in twin among which 1 cabin with 1 additional pullman bed
2 double front cabins of which one with communication in the front peak fitted with a single bed
Ensuite bathroom in each cabin
Number of guests: 8 adults + 2 children
Air-conditioned cabins, saloon

COMFORT

Air conditioned wine cellar

HI-FI with speakers inside and outside
Saloon: TV plasma, DVD's, CD's, games console Wii
TV on each cabin

EQUIPMENT

Engines: 2 x 110 HP VOLVO
Generator: KOLHER 13 KVA
Water tank: 825 Liters
Fuel tank: 1100 Liters
Cruising speed: 12
Fuel Consumption: 10 Liters/Hr
Water maker: 180 Liters/Hr
5 converters 220 V/110 V

WATER SPORTS

Tenders + toys: dinghy 13.8ft with 40 HP
Wake board – 2 rigid kayaks (2 pax)- Towing ring –
Windsurf - Floating Mats – Fishing gear – Snorkeling equipment
Rendez-vous diving on request

COMMUNICATIONS

COM SAT IRRIDIUM, VHF, INTERNET CONNEXION

REFIT 2010

General maintenance, new pillows of cockpit and bimini



Sailing



Passengers on the bow



Kayak



Snorkeling



Wake board



Cockpit table



Dining table



Saloon



Bar & Kitchen



Double cabin with ensuite bathroom



Nirvana



At anchor

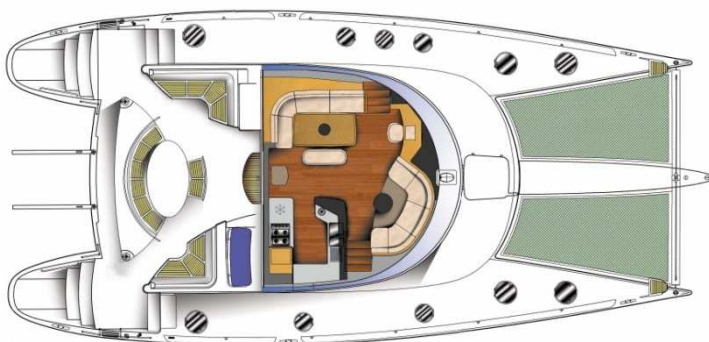

Deck plan

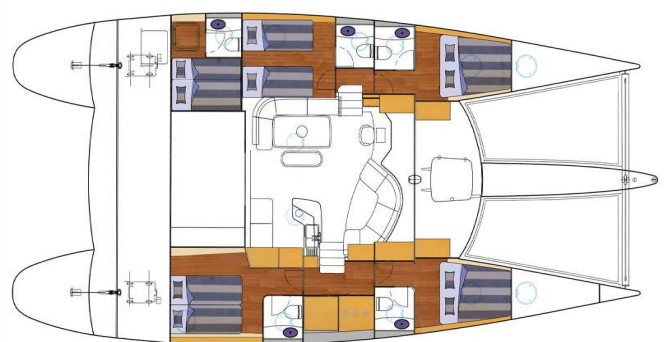

Layout Nirvana